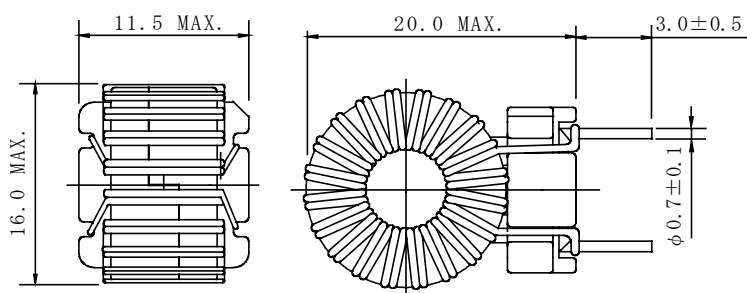
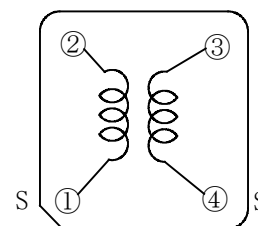

Type: SFC1015
◆ Product Description

- 16.0×11.5mm Max.(L×W), 20.0mm Max. Height .
- Inductance range: 2.0mH
- Rated current range: 1.3A
- In addition to the standard versions of parameters shown here, custom designs are available to meet your exact requirements.

◆ Feature

- Ideally used as noise filter chokes for power supply circuit(secondary) of FAX machine in high frequency range.
- RoHS Compliance

◆ Dimensions (mm)

◆ Schematics (Bottom)

“S” is winding start

- * Dimension does not include solder used on coil.
- * Terminal pitch is measured at the base(not from tip of the pin)

◆ Specification

Part No. SFC1015NP-202

		Measuring conditions
Inductance (1-2) or (4-3)	2.0mH MIN.	1kHz,0.1V
D.C.R. (1-2) or (4-3)	250mΩ MAX.	at 20℃
Rated current (1-4) ※1	1.3A(1.6ATYP.)	2 and 3 to be shorted

※1.Rated current:The DC current at which the temperature rise is $\Delta t=40^{\circ}\text{C}$.($T_a=20^{\circ}\text{C}$).