

SMD Power Inductor

CDH30D14/H125

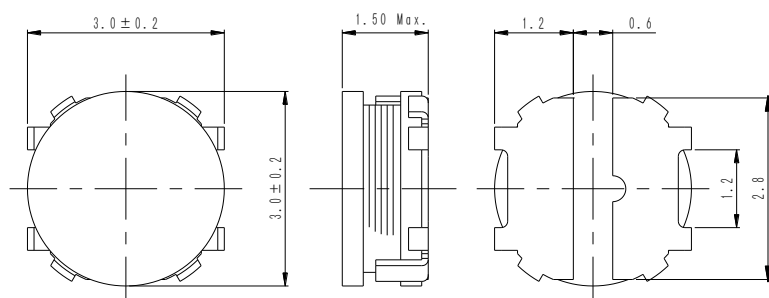

Dimension - [mm]



Land pattern and Schematics - [mm]

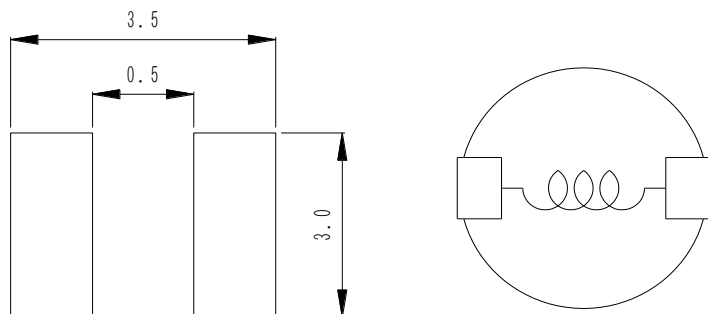

Description

- Ferrite drum core construction.
- Magnetically unshielded.
- L × W × H: 3.2 × 3.2 × 1.5 mm Max.
- Product weight: 48mg(Ref.)
- Moisture Sensitivity Level: 1
- RoHS compliance.
- Qualification to AEC-Q200.

Environmental Data

- Operating temperature range: -40°C ~ +125°C (including coil's self temperature rise)
- Storage temperature range: -40°C ~ +125°C
- Solder reflow temperature: 260 °C peak.

Packaging

- Carrier tape and reel packaging
- 7" diameter reel
- 1000pcs per reel

Applications

- Automotive and other high temperature, high reliability application.

SMD Power Inductor

CDH30D14/H125

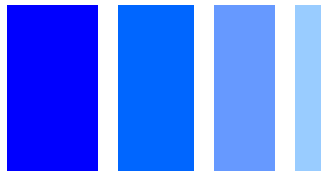

Electrical Characteristics

Part Name	Stamp	Inductance (μ H) [Within] ※1	D.C.R. (m Ω) [Within] (at 20°C)	Allowable D.C. bias current (A)※2		Temperature rise current (A) ※3
				(at 20°C)	(at 125°C)	
CDH30D14H125NP-1R0MC	A	1.0 \pm 20%	55 \pm 25%	2.7	2.2	2.3
CDH30D14H125NP-2R2MC	B	2.2 \pm 20%	105 \pm 25%	1.9	1.5	1.6
CDH30D14H125NP-3R3MC	C	3.3 \pm 20%	155 \pm 25%	1.5	1.3	1.3
CDH30D14H125NP-4R7MC	E	4.7 \pm 20%	200 \pm 25%	1.3	1.1	1.2
CDH30D14H125NP-5R6MC	D	5.6 \pm 20%	250 \pm 25%	1.1	0.95	0.90
CDH30D14H125NP-6R8MC	G	6.8 \pm 20%	350 \pm 25%	1.0	0.80	0.78
CDH30D14H125NP-100MC	F	10.0 \pm 20%	520 \pm 25%	0.95	0.70	0.64

※1 Measuring frequency inductance at 100kHz, 1V.

※2 Allowable D.C. bias current: the value of D.C. current when inductance is above 70% of its initial value.

※3 Temperature rise current: the actual value of D.C. current when temperature of coil increased

$\Delta T=40^{\circ}\text{C}$ ($T_a=20^{\circ}\text{C}$).

SMD Power Inductor CDH30D14/H125



Saturation Current & Temperature Rise Graph

— L (20°C) — L (125°C) — ΔT

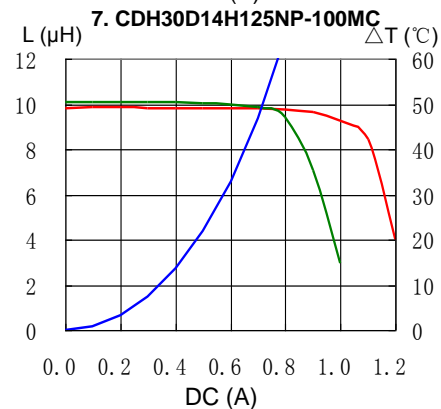
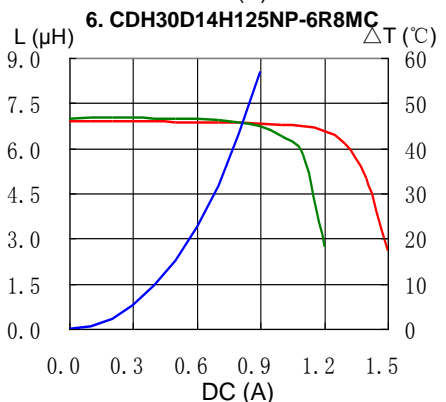
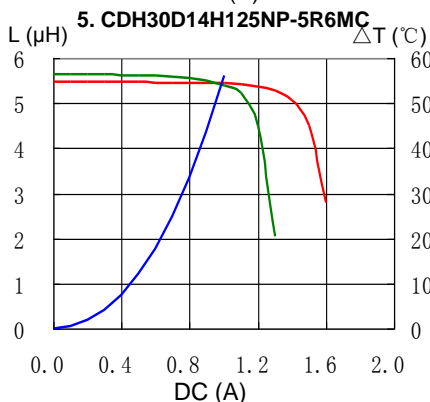
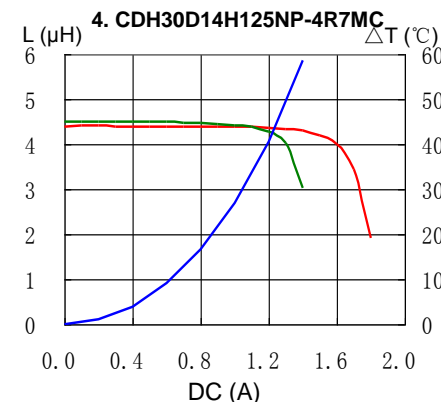
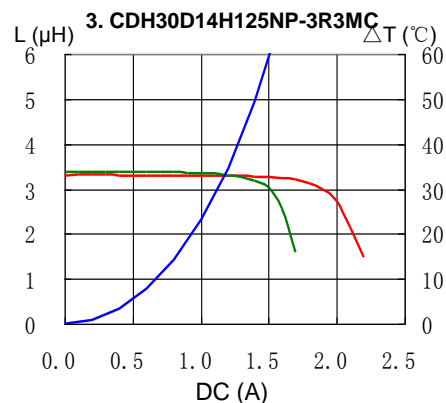
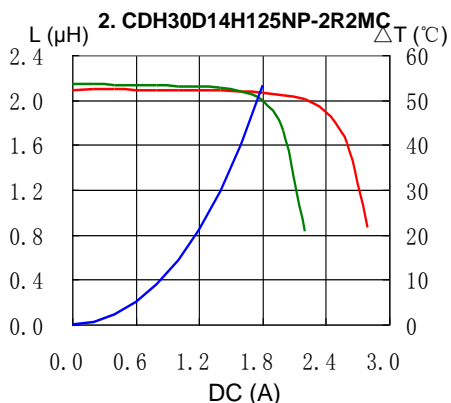
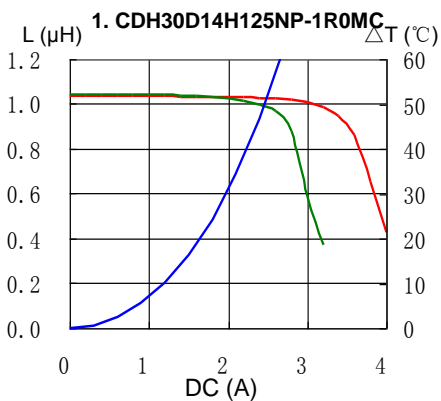

SMD Power Inductor

CDH30D14/H125



Solder Reflow Condition

