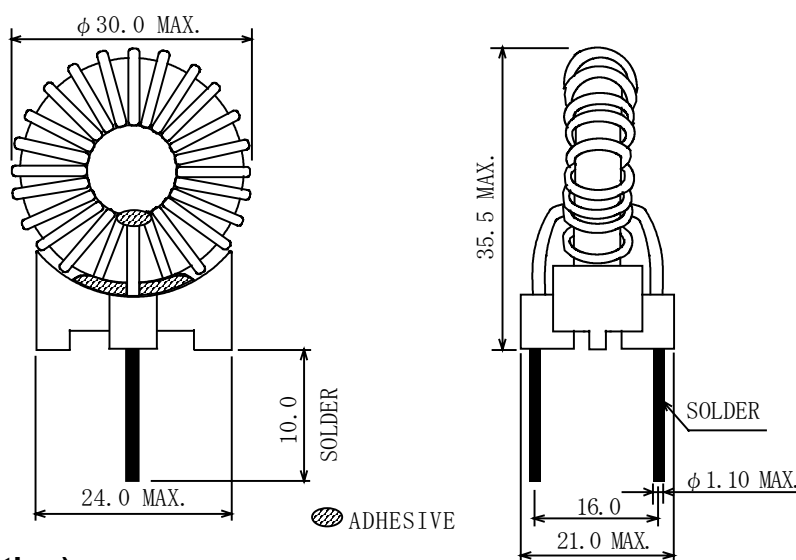

**Type: PFN2029**
**◆ Product Description**

- $\phi 30.0\text{mm} \times 35.5\text{mm}.$ MAX.
- Custom design is available

**◆ Feature**

- Iron dust core is used to realize better DC Saturation characteristics and higher noise absorption effect.
- Less leakage magnetic flux .
- Ideally used as Normal Mode chokes EMI suppression in power supplies or signal lines.
- Ideally used as Power Factor Correction choke
- Elimination for impulse noise.
- RoHS Compliance

**◆ Dimensions (mm)**

**◆ Specification (For EMC application)**

Sample No.	Inductance ( $\mu\text{H}$ ) [MIN.] At 1kHz	D.C.R.( $\text{m}\Omega$ ) [MAX.] (at20°C)	Rated Current (A)※1
PFN2029NP-NM42A	52	30	6.1
PFN2029NP-NM53A	83	38	5.4

※ Rated current: The DC current at which the temperature rise is  $\Delta t=40^\circ\text{C}.$ ( $T_a=20^\circ\text{C}$ ).

**◆ Specification (For PFC application)**

Sample No.	Inductance( $\mu\text{H}$ ) At 1kHz	D.C.R. ( $\text{m}\Omega$ ) [MAX.] (at20°C)	Rated Current (A)※
5342-T010	$10.0 \pm 20\%$	8.5	10.0

※ Rated current: The DC current at which the inductance decreases to 90 % of it's initial value or when  $\Delta t=40^\circ\text{C}$ , whichever is lower( $T_a=20^\circ\text{C}$ ).